

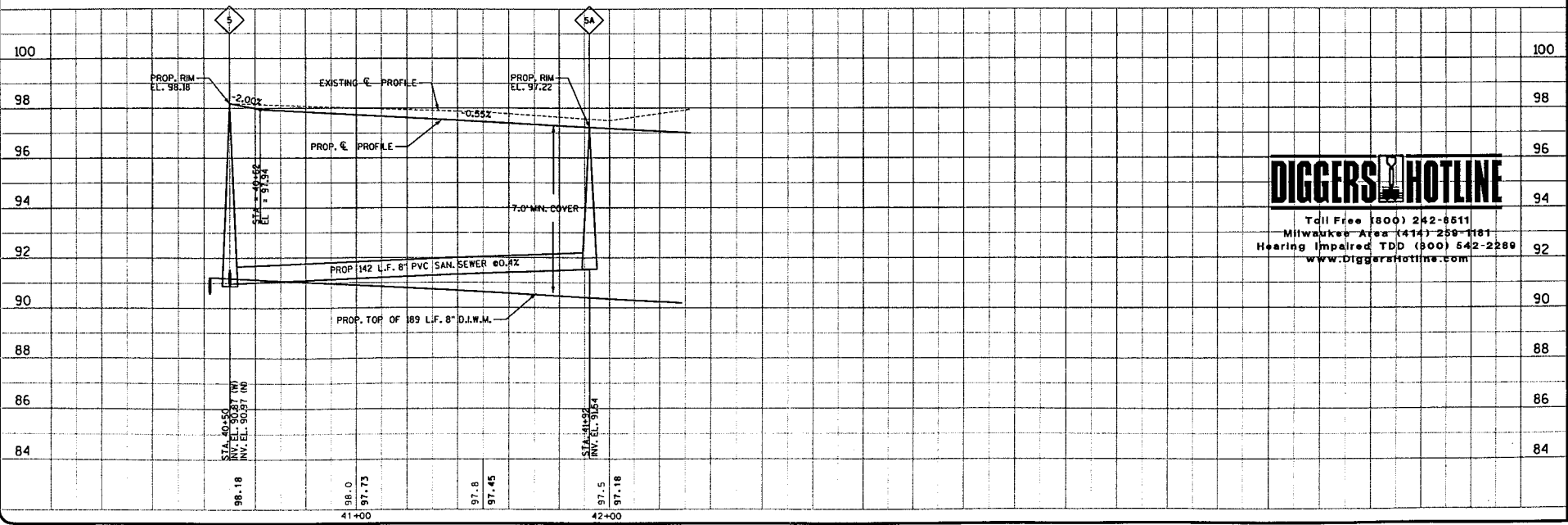

SEE SHEET #6

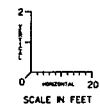
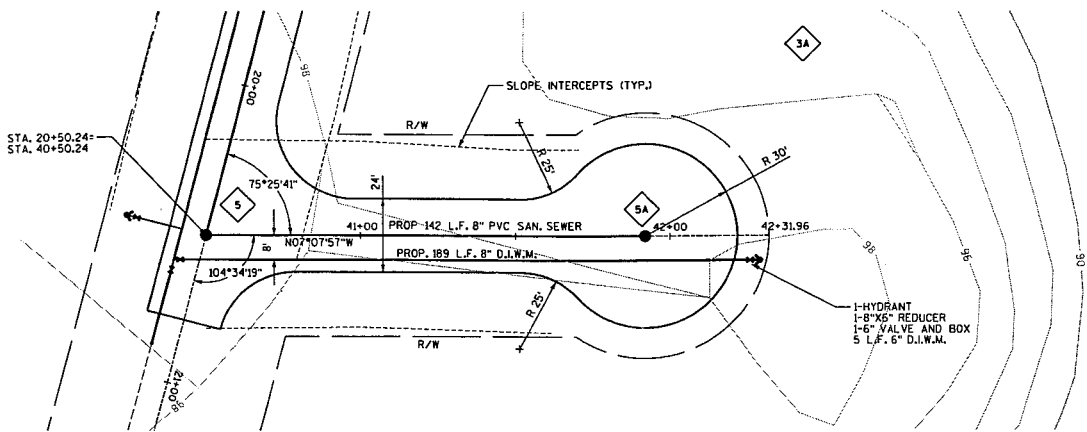

DIGGERS HOTLINE
 Toll Free (800) 242-8511
 Milwaukee Area (414) 259-1181
 Hearing Impaired TDD (800) 542-2288
 www.DiggersHotline.com

TEMPERATURE - MINORIAL
 DATE: 06/15/2002
 11115, Avenue 5, Milwaukee, WI 53208
 TEL: 414-381-1000 FAX: 414-381-1010
 © 2001 MSA ENGINEERING, INC.



PROJECT NO.	980373
DATE	06/15/2002
SCALE	AS SHOWN

TAX NO.	
DATE IN P.L.S.	
PROJECT NO.	314

DATE	06/15/2002
DATE	

PLAN AND PROFILE
 PTEHL SUBDIVISION
 UTILITIES
 TOMAHAWK, WISCONSIN

PROJECT NO.	980373
SHEET	9